

2MP Mini Fixed Bullet Network Camera

IPC2122LR3-PF40(60)M-D



Key Features

Optics

- Day/night functionality
- Smart IR , up to 30 m (98 ft) IR distance
- Optical glass window with higher light transmittance
- IR anti-reflection window to increase the infrared transmittance
- 2D/3D DNR (Digital Noise Reduction)

Compression

- Ultra 265,H.265, H.264, MJPEG
- ROI (Region of Interest)

Network

- ONVIF Conformance

Structure

- Wide temperature range: -30°C to 60°C (-22°F to 140°F)
- Wide voltage range of $\pm 25\%$
- IP67

Specifications

	IPC2122LR3-PF40M-D			IPC2122LR3-PF60M-D		
Camera						
Sensor	1/2.7", 2.0 megapixel, progressive scan, CMOS					
Lens	4.0mm@F2.0			6.0mm@F2.0		
DORI Distance	Lens	Detect(m)	Observe(m)		Recognize(m)	Identify(m)
	4.0mm	66.7	26.7		13.3	6.7
	6.0mm	90	36		18	9
Angle of View (H)	86.5°			55.4°		
Angle of View (V)	44.1°			30.2°		
Angle of View (O)	106.4°			68.1°		
Adjustment angle	Pan: 0°~360°		Tilt: 0°~90°		Rotate: 0°~360°	
Shutter	Auto/Manual, 1/6~1/100000 s					
Minimum Illumination	Colour: 0.02 Lux (F2.0, AGC ON) 0 Lux with IR on					
Digital noise reduction	2D/3D DNR					
Day/Night	IR-cut filter with auto switch (ICR)					
S/N	>52dB					
IR Range	Up to 30m (98 ft) IR range					
WDR	DWDR					
Video						
Video Compression	Ultra 265,H.265, H.264, MJPEG					
H.264 code profile	Baseline profile, Main Profile, High Profile					
Frame Rate	Main Stream:1080P (1920*1080): Max. 25 fps; Sub Stream:720P (1280*720): Max. 25 fps; Third Stream: CIF (352*288): Max. 25fps					
OSD	Up to 4 OSDs					
Privacy Mask	Up to 8 areas					
ROI	Up to 2 areas					
Motion Detection	Up to 4 areas					
Network						
Protocols	IPv4, IGMP, ICMP, ARP, TCP, UDP, DHCP, RTP, RTSP, RTCP, DNS, DDNS, NTP, FTP, UPnP, HTTP, HTTPS, SMTP, SSL					
Compatible Integration	ONVIF(Profile S), API					
Interface						
Network	10/100M Base-TX Ethernet					
General						
Power	12 V DC±25%, PoE (IEEE802.3 af)					
	Power consumption: Max 5.5W					
Dimensions (L × W × H)	167.3 × 62.9 ×62.7 mm (6.6" × 2.5" × 2.5")					
Weight	0.45kg (0.99 lb)					
Working Environment	-30°C ~ +60°C (-22°F ~ 140°F), Humidity :10%~90% RH(non-condensing)					
Ingress Protection	IP67					

Dimensions

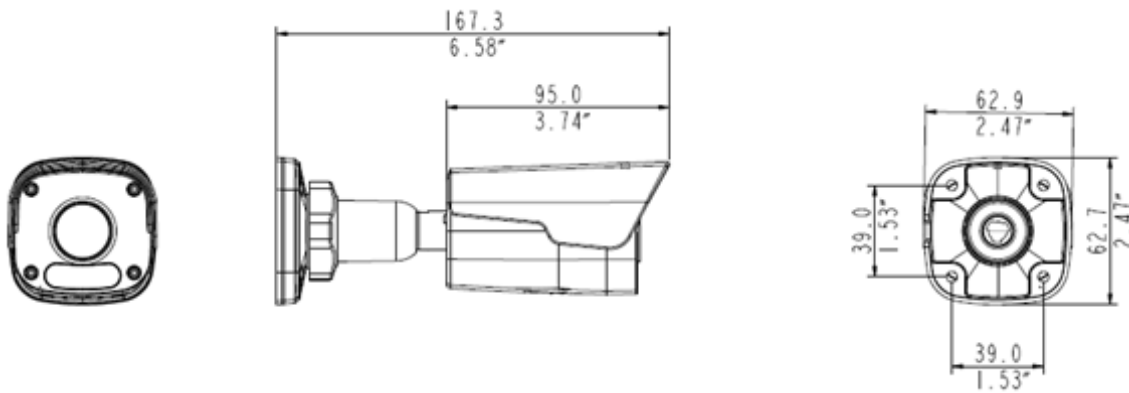

*

Zhejiang Uniview Technologies Co., Ltd.

Building No.10, Wanlun Science Park, Jiangling Road 88, Binjiang District, Hangzhou, Zhejiang, China (310051)

Email: overseasbusiness@uniview.com; globalsupport@uniview.com

<http://www.uniview.com>

©2018 Zhejiang Uniview Technologies Co., Ltd. All rights reserved.

*Product specifications and availability are subject to change without notice.