

HVP8416

H.264 Pentaplex 720P Real Time Recording NVR

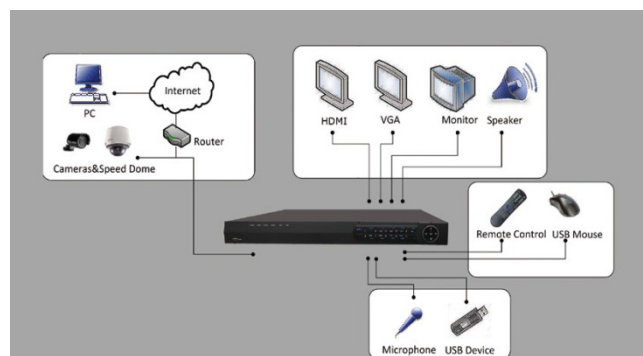

Key Features

- **H.264 video compression**
- **720P real-time recording**
- **HDMI & VGA output at up to 1920x1080P resolution.**
- **Dual-stream**
- **16ch 720p, 8ch 1080p synchronous playback**
- **HDD up to 4TB each**

		HVP 8416
Video/Audio input	IP video input	16-ch
	Two-way audio input	1-ch, BNC (2.0 Vp-p, 1kΩ)
	Incoming / Outgoing bandwidth	80Mbps / 240Mbps
Video/Audio output	Recording resolution	5MP/3MP/1080P/UXGA/720P/VGA/4CIF/DCIF/2CIF/CIF/QCIF
	Frame rate	Main / Sub Stream : 25 fps (P) / 30 fps (N)
	HDMI/VGA OUTPUT	1-ch resolution: 1920x1080x60Hz, 1920x1080x50Hz, 1600X1200X60hZ, 1280x1024x60Hz
	CVBS (optional)	1-ch, BNC (1.0Vp-p, 75Ω) Resolution : 704 x 576 (PAL), 704 x 480 (NTSC)
	Audio Output	2-ch, BNC (Linear electrical level, 600Ω)
	Live/ Playback resolution	5MP/3MP/1080P/UXGA/720P/VGA/4CIF/DCIF/2CIF/CIF/QCIF
Decoding	Capability	16ch 720p, 8ch 1080p
Hard disk	SATA	4 SATA interface for 4 HDDs
	Capacity	Up to 4TB each
External Interface	Network interface	1 RJ45 10 / 100 / 1000Mbps Self-adaptive Ethernet interface
	Serial interface	1 RS-232 interface; 1 RS-485 interface
	USB interface	3 × USB 2.0
	Alarm input	16 ch
	Alarm output	4 ch
	Interface	16 independent 100 Mbps PoE network interfaces
	Max. Power	200W
	Supported Standard	AT and AF
General	Power supply	100~240VAC, 6.3A, 50~60Hz
	Consumption	≤ 40W (without hard disk or DVD-R/W)
	Working temperature	-10℃ ~ 55℃
	Working humidity	10% ~ 90%
	Chassis	19-inch rack-mounted 1.5U chassis
	Dimensions (W × D × H)	445 x 390 x 70mm
	Weight	≤ 4 Kg (without hard disk)